

VICSES Cobram

Update from the Emergency Services Infrastructure Authority

Project Update | March 2021

- The lease for 34 Ritchie Road, Cobram, with street frontage on to Cobram-Koonoomoo Road has been established.
- The schematic design for the new facility was approved by the Sector Coordination Group on 4 July 2019.
- ESIA acknowledges that some time has passed since, and a project start-up meeting was held on 4 February 2021 to re-introduce the project team and re-establish communications associated with project progression.
- The schematic design of the facility was updated to improve traffic flow and emergency vehicle movements.
- The town planning drawings and application have been updated to include the 20m communications tower, revised landscape design, traffic flow and additional site signage.
- Once town planning revisions are accepted, ESIA will proceed with the detailed design documentation. During that time ESIA will also engage with the Unit to finalise the design.



New site on Cobram-Koonoomoo Road

Next Steps

- Outcome of town planning application.
- Detailed design completion.

Project Timeline

Site identification

Complete

Site due diligence

Complete

Land acquisition

Complete

Concept, schematic and design development

Proceeding to detailed design stage

Town planning and zoning approvals

In progress

Procure and appoint construction firm

Planning underway

Construction commences

Early 2022

Construction concludes

Late 2022

Commissioning of facility

Late 2022

Handover of facility

Late 2022

Schematic and detailed designs

ESIA has previously explained concept designs, which are standardised layouts for all new VICSES unit facility types. However, not all VICSES units have the same responsibilities, so how do we accommodate these different requirements in your facility's design?

Schematic design

Schematic designs apply the relevant concept design (standardised) to a specific site once it has been identified. Factors including land size, street frontage, easements and planning overlays are considered, in addition to the functional requirements of the unit.

The schematic design (also known as a site plan) also considers site investigation reports (e.g. geo-technical, cultural, arborist etc.), which help to determine how the facility will be configured on the site and enables an initial cost estimate to be generated.

This process can take up to four months with the schematic design submitted as part of the town planning application.

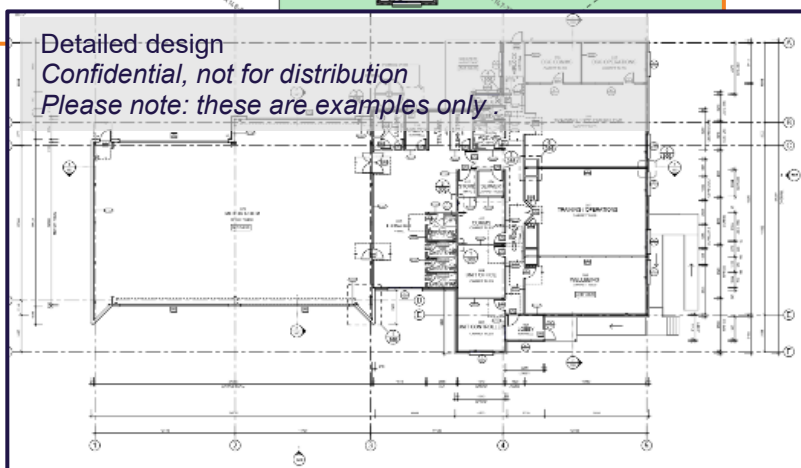
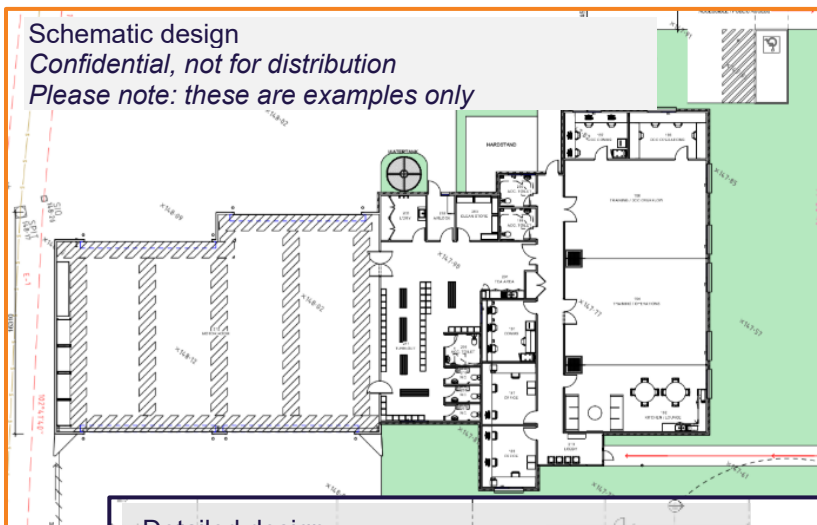

Who has input into the design process?

The schematic and detailed design processes are a collaborative approach between ESIA, VICSES HQ and your Regional Manager. Regional Managers will work closely with their respective units to ensure functional requirements are met, and critical issues addressed. The specific facility designs are overseen by the Project Control Groups, with approval required from the Sector Coordination Group (SCG).

Detailed design

The next phase is detailed design, which commences once a planning permit is issued, enabling any council requirements to be considered.

Detailed design develops the schematic into drawings, plans and specifications and includes everything from site excavation (civil works) to the type of door handles, lighting, power points and furniture required.

This process is very comprehensive and can take up to four months. Once approved by the SCG, the documentation is released through a Request for Tender to source a suitable builder to construct the facility.

Contact

esiases@justice.vic.gov.au

Website

www.esia.vic.gov.au