

# VICSES Cobram

## Update from the Emergency Services Infrastructure Authority

### Project Update | June 2021

- The long-term lease for 34 Ritchie Road, Cobram, with street frontage on to Cobram-Koonoomoo Road has been established.
- The schematic design for the new facility was approved by the Sector Coordination Group on 4 July 2019 and subsequently updated to improve traffic flow and emergency vehicle movements.
- The revised drawings have been issued for town planning approvals.
- Detailed design documentation has progressed concurrently. Once completed, ESIA will engage with the Unit to finalise.

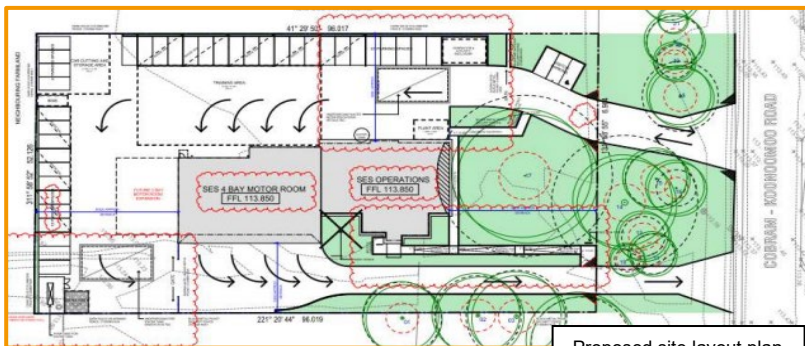

### Next Steps

- Receive outcome of submitted town planning application, with approval expected to take up to three months.
- Detailed design completion subject to town planning considerations.

*This update is current at time of distribution, however due to unforeseen circumstances, changes may occur.*

### Project Timeline

#### Site identification

Complete

#### Site due diligence

Complete

#### Land acquisition

Complete

#### Concept designs

Complete

#### Schematic design

Complete

#### Town planning and zoning approvals

Submitted to Council

#### Detailed design

In progress

#### Procure and appoint construction firm

Late 2021

#### Construction commences

Early 2022

#### Construction concludes

Late 2022

#### Commissioning of facility

Late 2022

#### Handover of facility

Late 2022

# Schematic and detailed designs

ESIA has previously explained concept designs, which are standardised layouts for all new VICSES unit facility types. However, not all VICSES units have the same responsibilities, so how do we accommodate these different requirements in your facility's design?

## Schematic design

Schematic designs apply the relevant concept design (standardised) to a specific site once it has been identified. Factors including land size, street frontage, easements and planning overlays are considered, in addition to the functional requirements of the unit.

The schematic design (also known as a site plan) also considers site investigation reports (e.g. geo-technical, cultural, arborist etc.), which help to determine how the facility will be configured on the site and enables an initial cost estimate to be generated.

This process can take up to four months with the schematic design submitted as part of the town planning application.

## Who has input into the design process?

The schematic and detailed design processes are a collaborative approach between ESIA, VICSES HQ and your Regional Manager. Regional Managers will work closely with their respective units to ensure functional requirements are met, and critical issues addressed. The specific facility designs are overseen by the Project Control Groups, with approval required from the Sector Coordination Group (SCG).

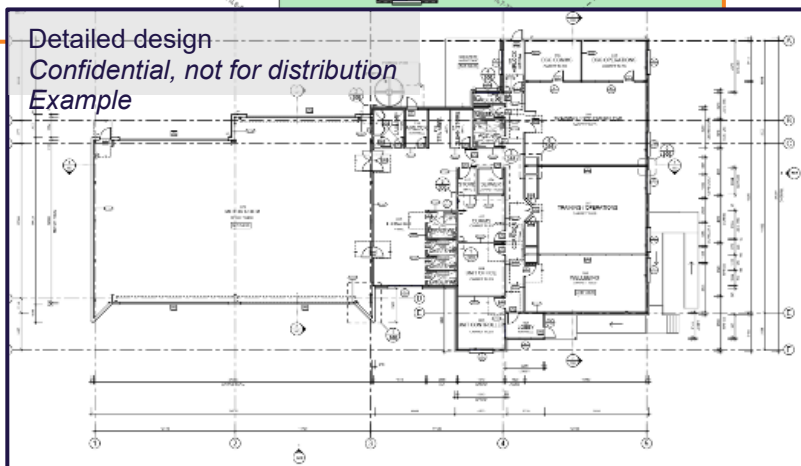
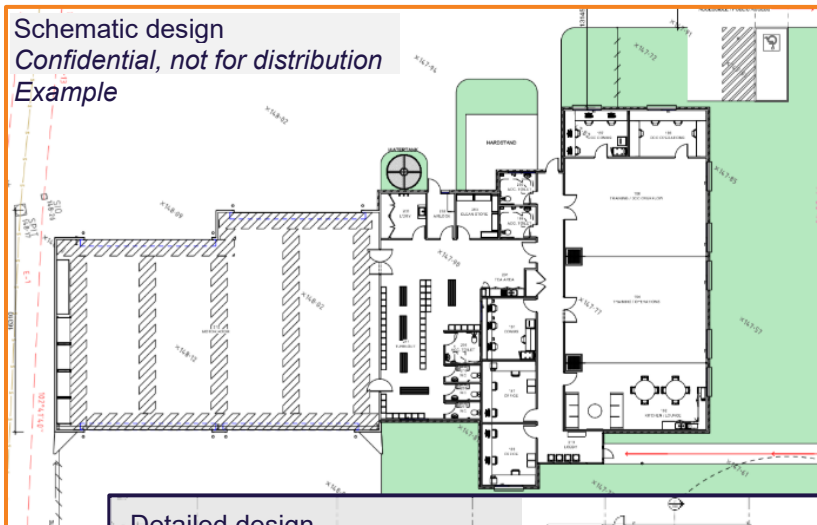

## Detailed design

The next phase is detailed design, which commences once a planning permit is issued, enabling any council requirements to be considered.

Detailed design develops the schematic into drawings, plans and specifications and includes everything from site excavation (civil works) to the type of door handles, lighting, power points and furniture required.

This process is very comprehensive and can take up to four months. Once approved by the SCG, the documentation is released through a Request for Tender to source a suitable builder to construct the facility.

## Contact

[esiases@justice.vic.gov.au](mailto:esiases@justice.vic.gov.au)

## Website

[www.esia.vic.gov.au](http://www.esia.vic.gov.au)